

Neoprene and Silicone Air Ducting Hose

Neoprene Air Duct Widely used for cockpit cooling and other low pressure ducting applications. Contains a bronze coated spring-steel wire support helix. The fiberglass fabric cover and fiberglass cord are both impregnated and coated with neoprene rubber. The temperature limit is 300°F. The maximum continuous length available is 12 feet. The 2.00, 2.50 and 3.00 inch diameter duct is available in 6 or 12 foot lengths only. Shorter pieces can be screwed together to form a continuous length.

<i>Neoprene Air Duct, 2.0 inch I.D.</i>	<i>Part No. 3620-2.00-6 foot</i>	<i>\$29.94 per 6 foot length</i>
<i>Neoprene Air Duct, 2.0 inch I.D.</i>	<i>Part No. 3620-2.00-12 foot</i>	<i>\$51.24 per 12 foot length</i>
<i>Neoprene Air Duct, 2.5 inch I.D.</i>	<i>Part No. 3620-2.50-6 foot</i>	<i>\$33.99 per 6 foot length</i>
<i>Neoprene Air Duct, 2.5 inch I.D.</i>	<i>Part No. 3620-2.50-12 foot</i>	<i>\$58.29 per 12 foot length</i>
<i>Neoprene Air Duct, 3.0 inch I.D.</i>	<i>Part No. 3620-3.00-6 foot</i>	<i>\$35.99 per 6 foot length</i>
<i>Neoprene Air Duct, 3.0 inch I.D.</i>	<i>Part No. 3620-3.00-12 foot</i>	<i>\$68.99 per 12 foot length</i>
<i>Neoprene Air Duct, 4.0 inch I.D.</i>	<i>Part No. 3620-4.00-3 foot</i>	<i>\$24.59 per 3 foot length</i>
<i>Neoprene Air Duct, 4.0 inch I.D.</i>	<i>Part No. 3620-4.00-6 foot</i>	<i>\$44.76 per 6 foot length</i>
<i>Neoprene Air Duct, 4.0 inch I.D.</i>	<i>Part No. 3620-4.00-12 foot</i>	<i>\$79.92 per 12 foot length</i>

Silicone Rubber Air Duct Construction is the same as above except uses high-temperature silicone rubber instead of neoprene. This allows operation up to 550°F which makes this extremely popular for brake cooling ducts. The maximum continuous length is 12 feet; 2.00, 2.50 and 3.00 inch diameter duct is available in 6 or 12 foot lengths only. Shorter pieces can be screwed together to form a continuous length.

<i>Silicone Air Duct, 2.0 inch I.D.</i>	<i>Part No. 3621-2.00-6 foot</i>	<i>\$39.96 per 6 foot length</i>
<i>Silicone Air Duct, 2.0 inch I.D.</i>	<i>Part No. 3621-2.00-12 foot</i>	<i>\$69.96 per 12 foot length</i>
<i>Silicone Air Duct, 2.5 inch I.D.</i>	<i>Part No. 3621-2.50-6 foot</i>	<i>\$47.99 per 6 foot length</i>
<i>Silicone Air Duct, 2.5 inch I.D.</i>	<i>Part No. 3621-2.50-12 foot</i>	<i>\$86.99 per 12 foot length</i>
<i>Silicone Air Duct, 3.0 inch I.D.</i>	<i>Part No. 3621-3.00-6 foot</i>	<i>\$54.99 per 6 foot length</i>
<i>Silicone Air Duct, 3.0 inch I.D.</i>	<i>Part No. 3621-3.00-12 foot</i>	<i>\$98.99 per 12 foot length</i>
<i>Silicone Air Duct, 4.0 inch I.D.</i>	<i>Part No. 3621-4.00-3 foot</i>	<i>\$36.49 per 3 foot length</i>
<i>Silicone Air Duct, 4.0 inch I.D.</i>	<i>Part No. 3621-4.00-6 foot</i>	<i>\$63.96 per 6 foot length</i>
<i>Silicone Air Duct, 4.0 inch I.D.</i>	<i>Part No. 3621-4.00-12 foot</i>	<i>\$111.96 per 12 foot length</i>
<i>Silicone Air Duct, 5.0 inch I.D.</i>	<i>Part No. 3621-5.00-3 foot</i>	<i>\$42.69 per 3 foot length</i>
<i>Silicone Air Duct, 5.0 inch I.D.</i>	<i>Part No. 3621-5.00-6 foot</i>	<i>\$68.94 per 6 foot length</i>
<i>Silicone Air Duct, 5.0 inch I.D.</i>	<i>Part No. 3621-5.00-12 foot</i>	<i>\$136.92 per 12 foot length</i>

New!

Now stocked in 2 inch diameter

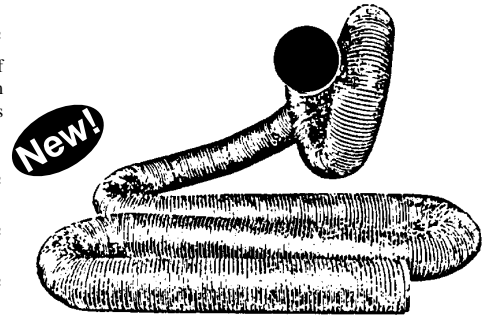

Thermo-formed Air Inlet Ducts

Computer Aided Design (CAD) and wind tunnel testing have been combined to produce these ducts. Attention to detail results in maximum air flow with minimal drag. They are molded from tough, high-impact clear or black plastic. An integrally molded flange (approximately .75" wide on most ducts) makes them easy to install in body panels, air dams or side windows. The outlet nipples are sized to fit our air ducting hose (see above).

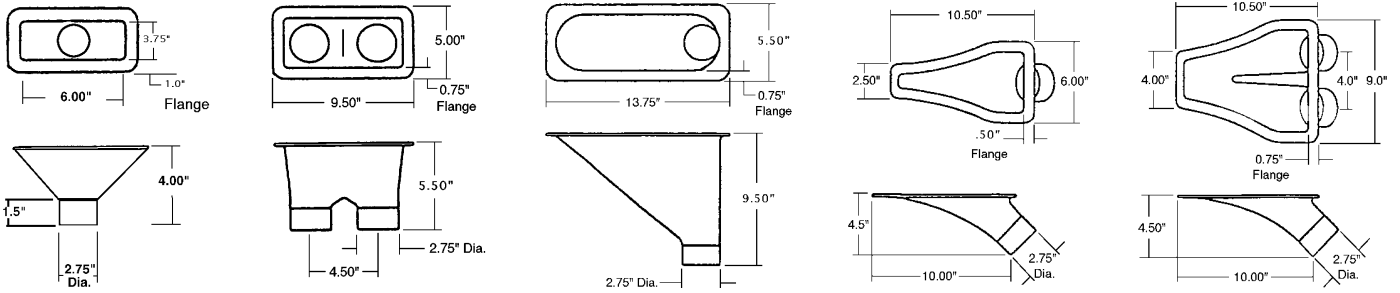

Headlight Mount Air Inlet
Part No. 3623

Headlight Mount Air Inlet, single outlet for 3" hose ... Part No. 3623-Black. \$16.99
Approximately 6 x 3.75 inches (rectangular).

Small Bumper Mounted Inlet, single outlet for 3" hose . Part No. 3624-Black. \$21.99
Size is approximately 9.5 x 5 inches.

Small Bumper Mounted Inlet, dual outlets for 3" hose . Part No. 3625-Black. \$21.99
Size is approximately 9.5 x 5 inches.

Large Bumper Mounted Inlet, single outlet for 3" hose . Part No. 3626-Black. \$23.99
Size is approximately 13.75 x 5.5 inches.

Medium NACA Duct
Part No. 3628

Small NACA Duct, Black, single outlet for 2.5" hose ... Part No. 3627-Black. \$17.99
Small NACA Duct, Clear, single outlet for 2.5" hose ... Part No. 3627-Clear. \$24.99
Size is approximately 7 x 3.7 inches.

Medium NACA Duct, Black, single outlet for 3" hose .. Part No. 3628-Black. \$18.99
Medium NACA Duct, Clear, single outlet for 3" hose ... Part No. 3628-Clear. \$26.99
Size is approximately 10.5 x 6 inches.

Large NACA Duct, Black, dual outlets for 3" hose Part No. 3629-Black. \$21.99
Large NACA Duct, Clear, dual outlets for 3" hose Part No. 3629-Clear. \$28.99
Size is approximately 10.5 x 9 inches.

Hydraulic Brake Light Switch



The **Hydraulic Brake Light Switch** provides a switch closure to activate brake lights. Has 1/8" NPT male threads.

Hydraulic Brake Light Switch with 1/8" NPT male threads
Part No. 3601 \$11.99

3AN Tee



The **3AN Tee** is used to connect the brake light switch to a 3AN brake line.

3AN Tee with female 1/8" NPT branch
Part No. 3209-02-03S \$8.59

Longacre Complete Brake Line Kit



This kit includes 4 stainless steel braided lines to go from the chassis to the wheels, an assortment of pre-flared bendable steel chassis lines, connectors, fittings, frame tabs, adel clamps and wire ties. There are enough parts to do almost any car from a Formula Ford to a Showroom Stock (does not include caliper fittings – see page 69).

Longacre Complete Brake Line Kit
Part No. 4521 \$109.99